

GKG

GL-Star

Above & Beyond Your Expectations



PERFORMANCE

Machine Alignment Capability	2 Crmk @ ±12.5 microns 6 sigma
Process Alignment Capability	2 Cpk @ ±20 microns 6 sigma
Core Cycle Time (excluding printing & cleaning time)	< 8.5 secs
Product Changeover Time	< 3 mins
New Product Setup Time	< 10 mins

BOARD HANDLING

Max. Size (L x W)	510 mm x 510 mm
Min. Size (L x W)	50 mm x 50 mm
Thickness	0.4~6 mm
PCB Thickness Adjustment	Automatic
PCB Max. Weight	5kg
PCB Edge Clearance	3 mm
PCB Bottom Clearance	23 mm
PCB Warpage	Max. 1% diagonally
Clamping Method	Auto retractable top clamp, motor controlled side clamp
Support Method	Magnetic support pins, bars, blocks, vacuum suction
Conveyor Direction	L to R, R to L, R to R, L to L (software control)
Conveyor Height	900 ± 40 mm
Conveyor Speed (max.)	1,500 mm/s
Conveyor Width Adjustment	Automatic

OPTICAL SYSTEM

Field-of-View (FOV)	10mm x 8mm
Fiducial Types	Circle, triangle, square, diamond, cross
Fiducial Size	0.5~4.0 mm
Vision Methodology	Digital CCD camera look up & down
2D Inspection	Max. 100 windows to inspect missing & insufficient (std.)

PRINTING PARAMETERS

Stencil Frame Size (L x W)	Adjustable, 470 mm x 370 mm to 737 mm x 737 mm
Print Gap (snap-off)	0~20 mm
Printing Table Adjustment Range	X: ±10 mm, Y: ±10 mm θ ± 2°
Print Speed	10~200 mm/s
Squeegee Pressure	0.5~10kg (program control)
Squeegee Type	Std.: Metal Squeegee 280mm, 350mm & 520mm. Option: Rubber
Squeegee Angle	Std. 60°, Option 45°, 50°, 55°
Cleaning System	Auto wet, dry, vacuum (Software select)

FACILITIES REQUIREMENT

Power Supply	AC220V ± 10% 50/60Hz
Power Consumption	3kW
Air Supply	4 ~ 6Kgf/cm ²
Air Consumption	5L/min
Dimension (excluding signal tower)	1,240 mm (L) x 1,560 mm (W) x 1,490 mm (H)
Machine Weight	1,200kg

OPERATOR INTERFACE

Hardware	LCD Monitor; Mouse & Keyboard
Operating System (OS)	Windows 7 or Higher
Control Method	Industrial PC controlled
I/O Interface	SMEMA Standard

OPTIONS

SPI closed-loop
Auto glue dispensing
Temperature, humidity monitoring & display
Internal/External barcode scanner for PCB traceability
Handheld barcode scanner for stencil, solder paste, squeegee traceability
MES system integration (For Ind. 4.0)
2 machines in series for higher output
2 machines back to back for dual lane SMT line

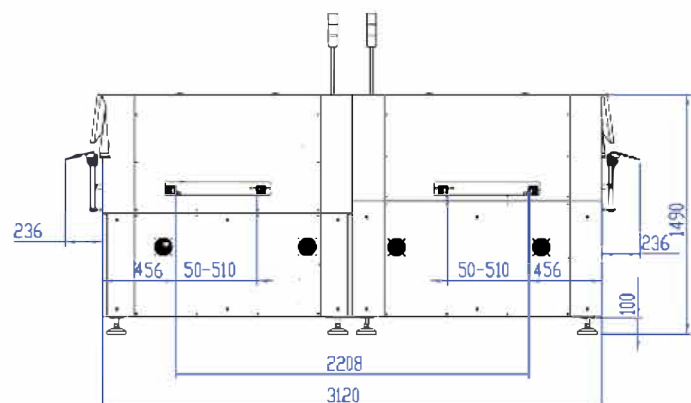
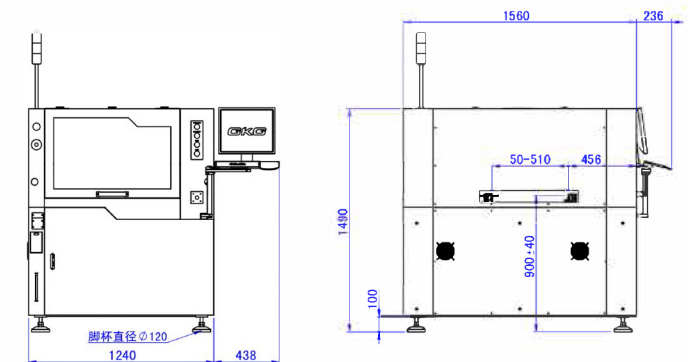

GKG

GKG ASIA PTE LTD

Global Marketing & Training Centre
Service & Spare Parts Support Centre
52 Ubi Avenue 3, #02-38 Frontier, Singapore 408867
Tel: +65 6547 8065 | Fax: +65 6547 5451
www.gkgasia.com

GKG PRECISION MACHINE CO., LTD.

Manufacturing - R&D Centre
No. 2 Shalang Road, Dong Cheng District Dongguan City
Guangdong Province China
Tel: +86 769 2276 7281, 3882 3222
Fax: +86 769 3882 0799
www.gkg.cn

